

PRODUCT No. 7369

Rectangular bin with an ashtray



(Illustrative photograph)

Technical data

Material	Steel sheet
Material thickness (housing/lid)	2 / 2 mm
Expansion hoop	Wire of 8 mm diameter
Capacity (bin/ashtray)	110 / 0,3 l
Weight	29,3 kg
Width	500 mm
Depth	380 mm
Height	1060 mm

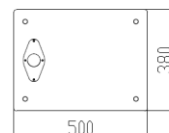
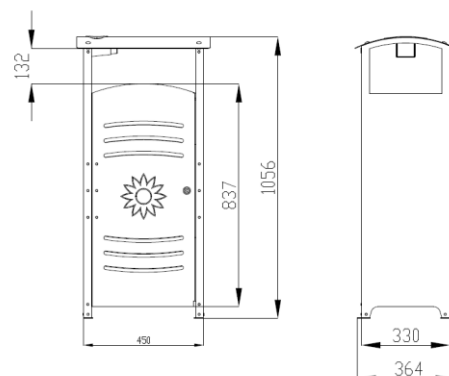

Attributes

- Made of galvanized steel sheet.
- All-metal bin with lockable doors.
- Bin's construction is riveted.
- A bag is placed inside the bin and hung behind the inner hoop.
- Removable ashtray placed in the lid with stainless steel fitting around the hole for throwing in the cigarette butts.
- Surface finishing is made by the base layer and then top layer of powder paint.
- Feet are fitted with four holes with 8 mm diameter for anchoring.

Color variations

- Standardly RAL 7011 (Grey).

Product purpose

- Designed for collecting of waste and cigarette butts, pro outdoor and indoor use.

Additions

- The bin can be used only when anchored and with inserted bag.
- Material for anchoring is not included.
- Bag can be ordered – type 1077.

