

### Catching basin for 1x 1000 l container – economic series TYPE: 3593E

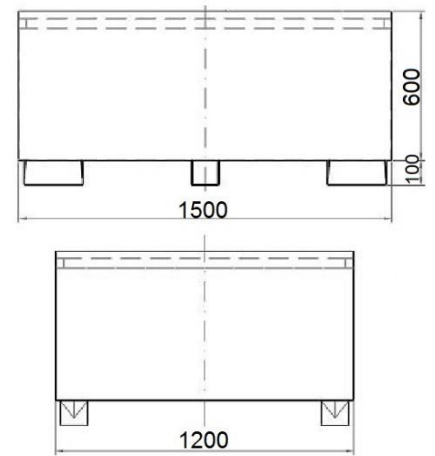

Illustrational photograph

#### TECHNICAL DATA

Material	Steel sheet
Sheet thickness	3 mm
Finishing (basin)	Varnished – green RAL 6029
Weight	172 kg
Load capacity	1500 kg
Capacity	1000 l
Width	1200 mm
Depth	1500 mm
Height	700 mm

#### ATTRIBUTES

- Catching basin equipped with 3x steel profiles.
- The basin is equipped for safe manipulation by means of fork-lift machinery.
- For safe storage of an IBC container with capacity of 1000 l.

#### COLOUR VARIATIONS

Green (RAL 6029).

#### PRODUCT PURPOSE

Product is designed for catching in of unwanted fluid leakage.

#### ADDITIONS

Catching basin must be in an empty state when is handled by a fork-lift machinery.