

### PRODUCT No. 7078

#### Barrel hinge – vertical



(Illustration photograph)

#### Technical data

Material	Steel
Weight	5,2 kg
Load capacity	320 kg
Max. lift	3 m
Width (min/max)	491/663 mm
Depth	180 mm
Height	505 mm
Burden	Barrel 572 mm

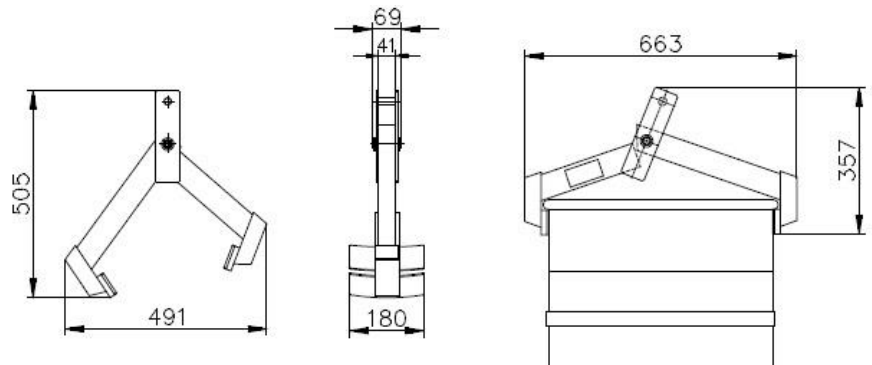

#### Attributes

- Made of steel / steel sheet.
- Vertical hinge of barrels is composed of two arms – one arm is equipped with fork with hinge pivot.
- Arms are connected with each other by pivot with casing.
- Both arms are equipped with supporting jaws for hanging and clamping the burden.
- Coupling pivot and casing have zinc-chrome surface finishing.
- For barrels with diameter 572 mm.

#### Color variations

- Yellow shade RAL 6200 (base layer S2000/0100 and top layer – synthetic paint 2300/0600 – yellow shade).

#### Product purpose

- Designed to handle with metal barrels in cases where handling in another way could be lengthy, difficult or dangerous.

#### Additions

- Hang devices cannot be used when the barrels are significantly deformed and cannot be surely held.
- Can be hung on a crane or other lifting device that has the required load capacity and is equipped with the appropriate hook.