

PRODUCT No. 3561

Plastic ashtray – black



(Illustrative photograph)

Technical data

Material	Polyethylene (PE)
Capacity	15 l
Weight	4,1 kg
Opening	89 x 50 mm
Diameter	305 mm
Height	965 mm

Attributes

- Made of high quality polyethylene (PE) plastic with a fire protection additive.
- Equipped with liner made of galvanized steel sheet.
- Ashtray design reduces oxygen access and thus avoids the risk of fire.
- The wide base ensures high stability.
- The ashtray can be anchored to the surface.
- It has opening with dimensions 89 x 50 mm – protects against throwing of waste.
- The container can be safely closed by means of a rotary shutter.

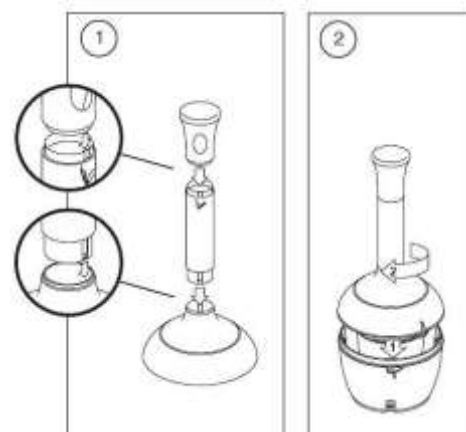

Color variations

- 3561 (Black).

Product purpose

- Designed for collecting of cigarette butts.

