

PRODUCT No. 3926

Drinking fountain Egea



(Illustration photograph)

Technical data

Material (body/drip grate/base)	Steel/galvanized steel/cast iron
Weight	42 kg
Diameter (hole/spacing)	12 / 305 mm
Diameter	190 mm
Height	1030 mm
Recommended pressure	0,8 – 1,2 bar

Attributes

- Made of steel and cast iron materials.
- The body is made of steel. The base and drip grate are made of cast iron.
- Very practical item of urban furniture.
- Used for refreshing in locations with high density of people.
- Standardly used color – RAL 6005 Polyester powdery paint.
- Suitable to be placed in – city centres, cultural monuments, parks, playgrounds etc.

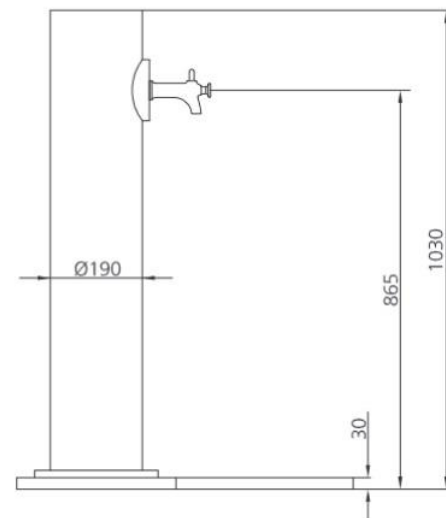

Product purpose

- Designed for refreshing in places with high concentration of people.

Additions

- Product for right functionality needs – be anchored to sturdy base, secured water supply.
- After pushing the button, waterflow is not consistent and the button needs to be pushed again.
- It is recommended to drain all of water and shut off the water intake in the winter season.